



Paradise Recreation & Park District

Agenda Prepared: 10/2/20
Agenda Posted: 10/2/20
Prior to: 3:00 p.m.

6626 Skyway
Paradise, CA 95969
Email: info@ParadisePRPD.com

Phone: 530-872-6393
Fax: 530-872-8619
Website: www.ParadisePRPD.com

NOTICE OF BOARD OF DIRECTORS COMMITTEE MEETING

Committee: Recreation & Park Committee (*Rodowick/Anderson*)
Date: Tuesday, October 6, 2020
Time: 4:00 p.m.
Location: Via Teleconference

Special Notice:

Pursuant to California Governor Gavin Newsom's Executive Order N-29-20 issued on March 17, 2020, relating to the convening of public meetings in response to the COVID-19 pandemic, the Paradise Recreation and Park District will be closing the Personnel Committee Meeting to members of the public and non-essential District staff.

The public may listen to this meeting via computer or telephone. The public may submit comments prior to the meeting via email to ccampbell@paradisepprd.com before 1:00 p.m. on the day of the meeting and they will be read into the record.

Join Zoom Meeting

<https://us02web.zoom.us/j/85763921525?pwd=akVLY2tNREU0QU1Lc2V1OHB6YkRpUT09>

Or via Telephone: Dial by your location: +1 669 900 9128 US (San Jose) (or) +1 346 248 7799 US (Houston)
Meeting ID: 857 6392 1525 Password: 641236

AGENDA:

The Committee will meet to:

1. Continue discussion regarding potential installation of a pet memorial in a District park to honor domestic pets lost to the 2018 Camp Fire.

Recommendation: Review proposed site locations and make a recommendation about whether to bring the issue before the full Board for consideration.

2. At Board direction, the Committee will review conceptual design options for Bille Park and Moore Road Park prepared by Melton Design Group.

https://paradisepprd.sharepoint.com/sites/BODMeeting/Shared Documents/_Committee.Park.Rec/RPC_2020_1006/20_1006_Agenda.Rec.Park.Cmte.docx

Staff Committee Report

September 9, 2020



DATE: 9/3/2020
TO: Board of Directors
FROM: Kristi Sweeney, Assistant District Manager
SUBJECT: Park and Recreation Committee Report

Attendance:

Committee Members: Steve Rodowick, Chair; and Robert Anderson, Member
PRPD Staff: Dan Efseaff, District Manager; Kristi Sweeney, Assistant District Manager;
Citizens: Ellen Michels, Gina Scheafer

The meeting convened at 2:30 pm.

The Park and Recreation Committee will depart the Terry Ashe Recreation Center at 2:40 p.m. to:

- 1. Tour selected District facilities for consideration of the possible installation of a pet memorial honoring animals lost in the 2018 Camp Fire; and**
- 2. Inspect completed and proposed improvements at these sites.**

Staff met with committee members and citizen participants at TARC, then traveled to Moore Rd Park and toured potential sites for a pet memorial and reviewed project work completed, in-progress, and pending at the park.

After the Moore Rd Park tour the group met at Bille Park and walked the site. Several potential sites were identified as favored for the pet memorial. Staff and committee members provided guidance to Gina Scheafer and Ellen Michels on process for approaching the full Board for consideration of the installation of a pet memorial at Bille Park.

The meeting adjourned at 4:35 pm.

https://paradisepprd.sharepoint.com/sites/BODMeeting/Shared Documents/_Committee.Park.Rec/RPC_2020_0901/PR.Staff.Report_20.0901.docx
9/30/2020

From: Gina Schaeffer <gina2u04@yahoo.com>
Sent: Tuesday, September 8, 2020 10:13 AM
To: Dan Efsaef <deffseaff@paradisepd.com>
Subject: Camp Fire Pet and Wildlife Memorial

To the Paradise Park and Recreations Committee:

I thank you for your consideration regarding a location for this memorial. I have reviewed the different sites that you proposed with our members. and the site near the pavilion, overlooking the ridge is the perfect home for this monument. (Pictures attached)

It is a peaceful, quiet place.

The tranquility in the atmosphere is perfectly appropriate, for those who come to grieve. Yet the whole area provides an invitation to them to return to this spot. The walking path is convenient access for anyone with physical disabilities, making less work for us to be ADA compliant. The nearby benches, grass and restrooms also make this space welcoming, and user-friendly for everybody.

But most importantly, the monument itself depicts the view of that very spot. It is a mirror-image in stone, of the living, breathing, nature that surrounds it.

There really is no perfect place for this memorial, except that spot.

*If, for some reason, that location is not an option, choice number two would in Bille Park also, near the pavilion but closer to the back entrance, on the left.

The third option, and less private, would be near the main entrance to Bille Park.

On behalf of the hundreds of survivors who are at the heart of my efforts in creating this monument to memorialize their pets, their livestock, and the wildlife that surrounded them before the Camp Fire.

Thank you for your consideration, and cooperation to make this memorial a reality.

Sincerely Gina Schaeffer.



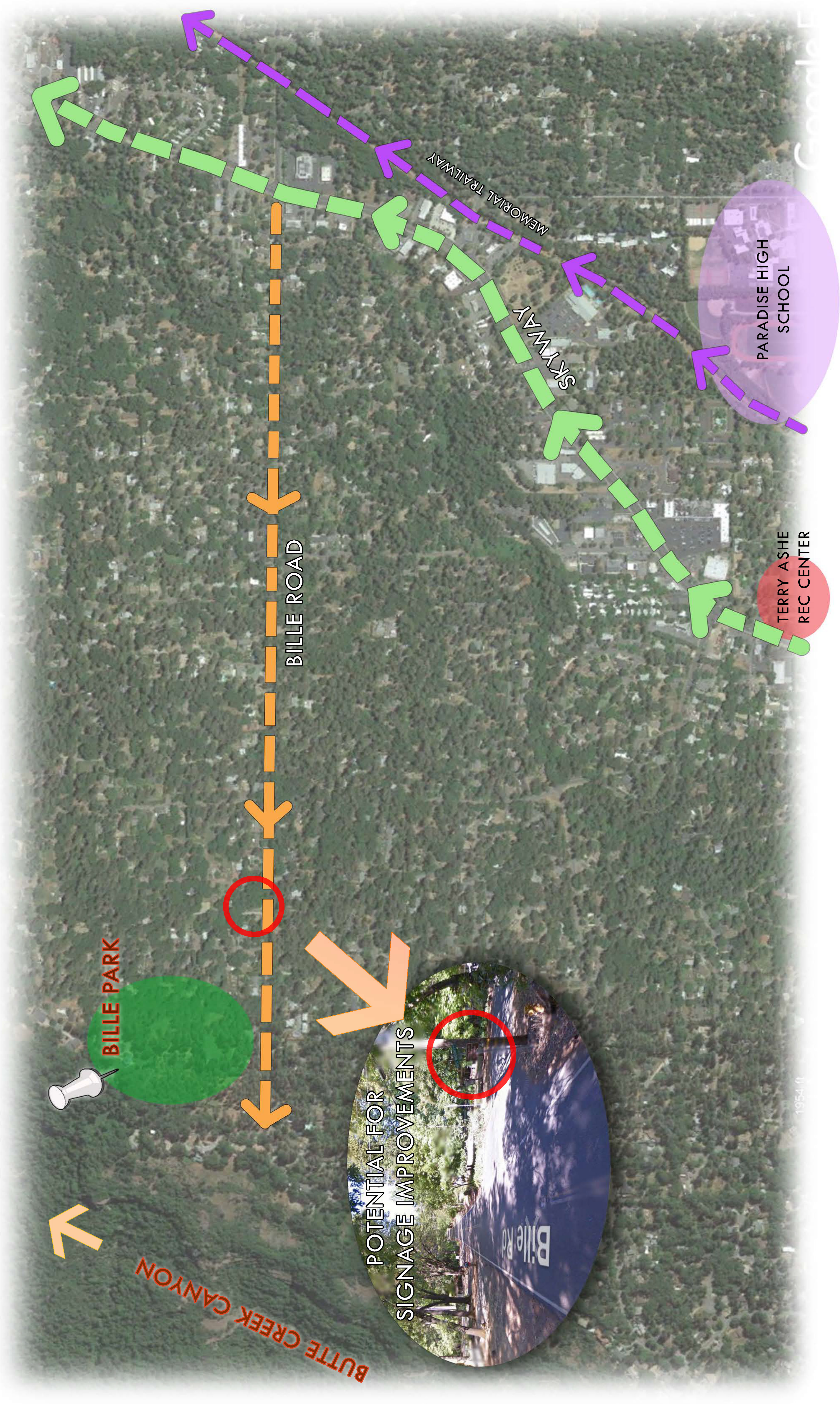

Google Earth

1954/1



BILLE PARK CONTEXT PLAN AND LOCATION MAP



VEHICULAR ENTRY FROM WAGSTAF

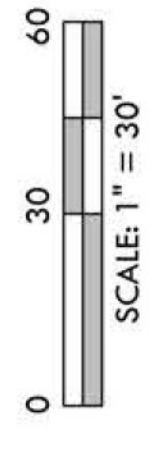

BILLE PARK SITE ANALYSIS AND EXISTING CONDITIONS



PROGRAM

- **THEME**
 - JOY/HOPE/CONNECTION
 - SHARED EXPERIENCES
 - NATURAL ENVIRONMENT
- **EVENTS**
 - EASTER EGG HUNTS
 - FAMILY GATHERINGS
 - PHOTOSHOOTS
 - CONCERTS
 - WEDDINGS/GRADUATIONS
 - BIRTHDAY PARTIES
 - CRAFT FAIR
- **PLAY**
 - FLOW & PUMP TRACK
 - ADVENTURE PLAY - ALL LEVELS
 - EMBANKMENT SLIDE
 - ZIPLINE CONNECTION
 - HIKING/JOGGING TRACK
 - ART OPPORTUNITY (HOPE)
 - CONNECTION TO ENVIRONMENT
- **LIGHTING**
 - RESTROOM/TOT LOT
 - BISTRO LIGHTS
 - FESTIVAL LIGHTS AT PARKING LOTS
- **FUNCTION/BEAUTY**
 - DRY CREEK
 - NEW VEGETATION/FIRE RESISTANCE
 - SCREENING



ADVENTURE/NATURAL PLAY



FLOW & PUMP TRACK



DRY CREEK/RAIN WATER CATCHMENT



OUTDOOR LEARNING & HIKING TRAILS

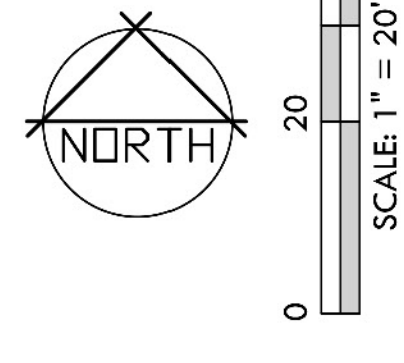



Giant Swamp



BILLYE PARK

THEME:
 JOY / HOPE / CONNECTION
 SHARED EXPERIENCES
 - NATURAL ENVIRONMENT -
 HEART → EXPERIENCE
 TO BE HAD.

IDENTITY

PROGRAM

- EVENTS
- EASTER EGG HUNTS
 - FAMILY GATHERINGS
 - PHOTO SHOOTS
 - GATHERINGS / CONCERTS
 - WEDDING / GRADUATIONS
 - BIRTHDAY PARTIES
 - CRAFT FAIR

LIGHTING

- RESTROOM / TOT LIGHT
- BISTRO LIGHTS / SEASONAL
- FESTIVAL LIGHTS AT PARKING LOTS
- SCREENING

PLAY

- PUMP / FLOW TRACK
- ADVENTURE PLAY - LEVELS
 - Embankment Slide
 - Zipline Connection
- FRISBEE GOLF
- FITNESS / JOGGING TRACK
- ART OPPORTUNITY (HOPE)
 - CONNECTION TO ENVIRONMENT

FUNCTION / BEAUTY

- DRY CREEK
- NEW VEGETATION / FIRE RESISTANCE

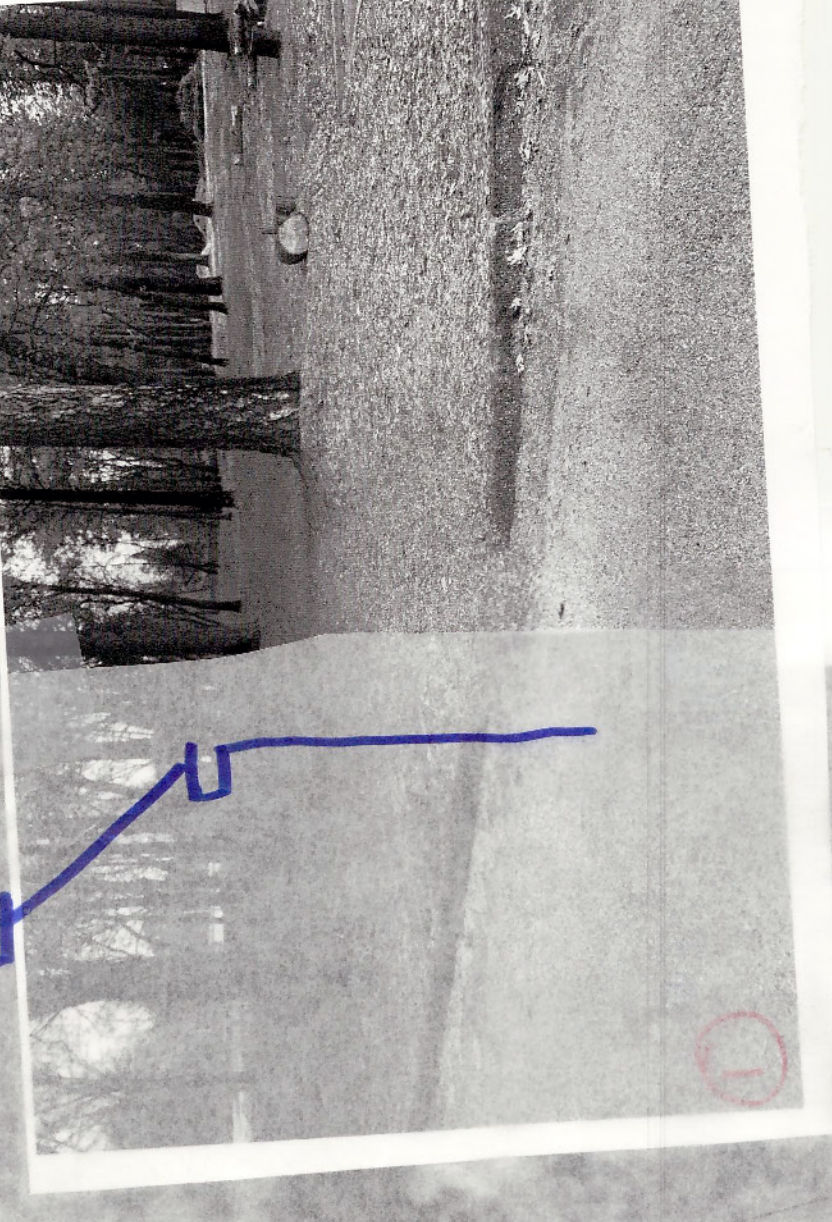
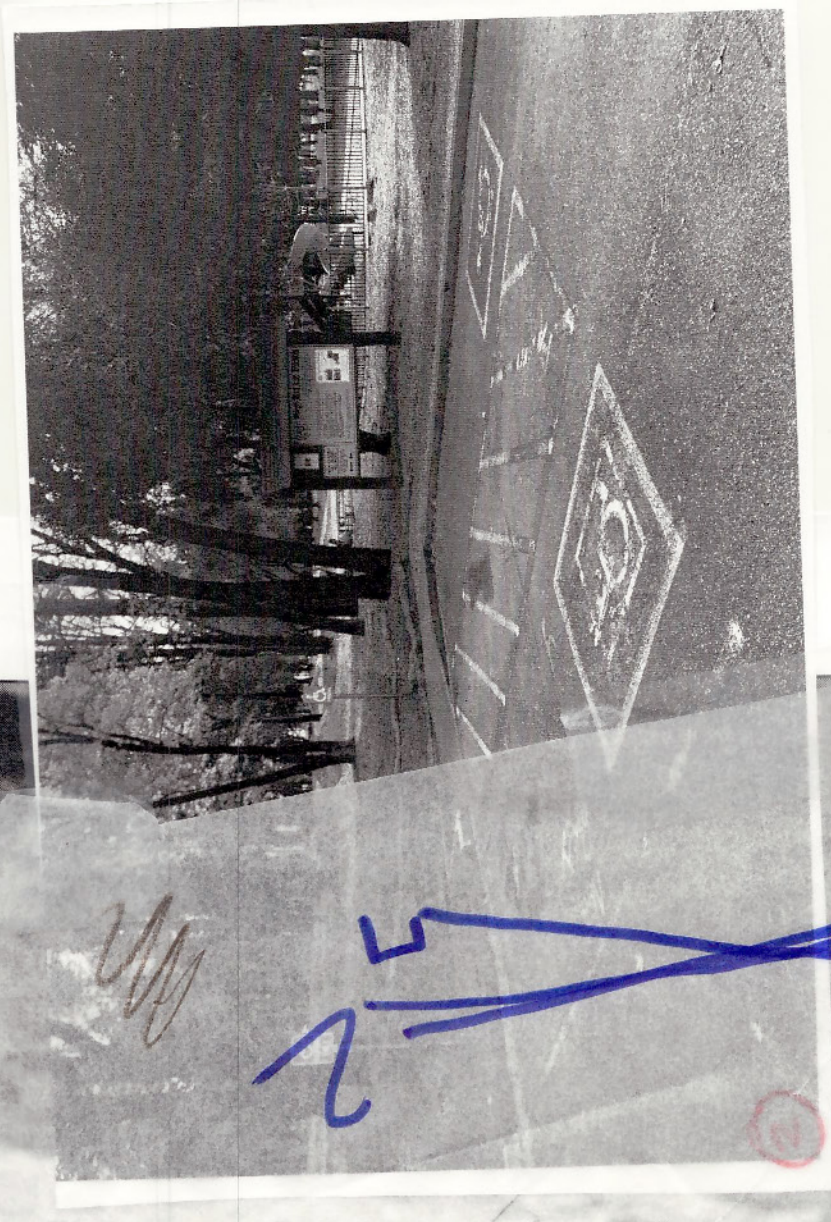

ROUGH / NATURAL
 ACTIVATE PLAY

RESIDENCES
 TRACK =
 3rd BUFFER
 2nd BUFFER
 NOISE BUFFER
 (Some to be rebuilt)

1" = 30'-00"

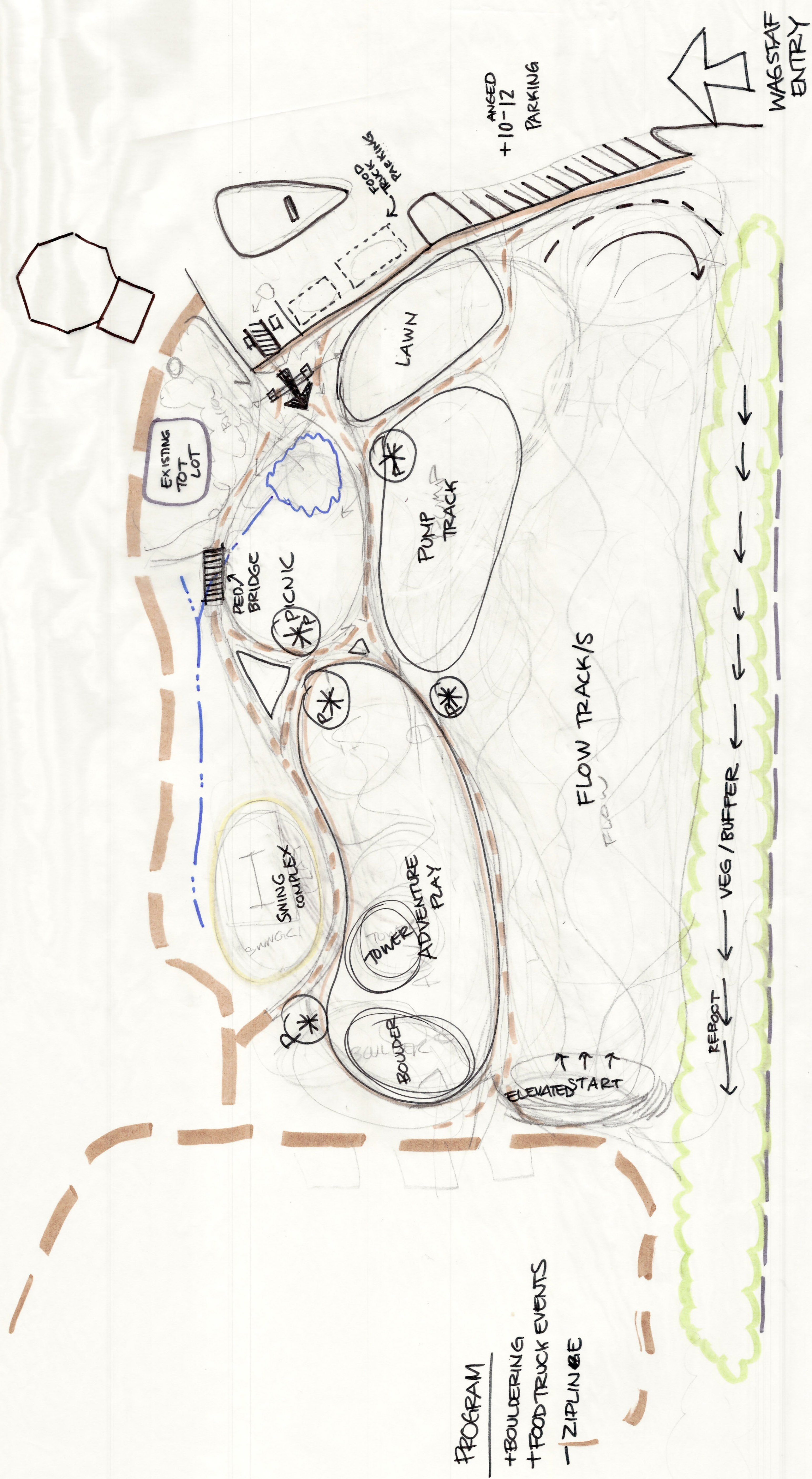

SCALE
1" = 30'
NORTH



ADDITIONAL CIRCULATION

- FORAGING AND EDUCATION PATH
- PICNIC AREAS
- ACCESS TO TOT LOT
- DRAINAGE CONNECTION & RETENTION BASIN

ADVENTURE PLAY

SWING COMPLEX

- 4 STANDARD SWINGS
- 1 BASKET SWING

ADVENTURE PLAYGROUND

- LARGE PLAY TOWER
- BOULDERING WALLS
- NATURAL BOULDERS AND LOGS
- ROPES AND SLACKLINES

FLOW TRACKS

- 3 FUN BIKE TRACKS:
- BEGINNER - ADVANCED COURSES
- RELOADING TRAIL
- BUFFERS AT TOP AND BOTTOM

EXPANDED PARKING LOT

- ADDITIONAL 28 PARKING STALLS
- 2 ACCESSIBLE STALLS
- EXPANDED ENTRANCES
- ENTRY ARCH

PUMP TRACKS

- TODDLER
- INTERMEDIATE
- VIEWING BLEACHERS & SEATING

PUMP TRACK

VEGETATION BUFFER

EXISTING RESIDENTIAL

Bille Park - OPTION 1

CONCEPTUAL DESIGN

PARADISE, CA

7-30-2020

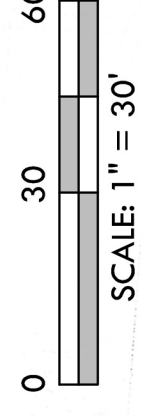
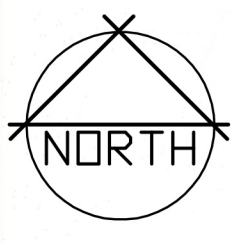

#2376





EXPANDED PARKING LOT

- ADDITIONAL 28 PARKING STALLS
- 2 ACCESSIBLE STALLS
- EXPANDED ENTRANCES
- ENTRY ARCH

ACCESS TO EXISTING TOT LOT & RESTROOM

PUMP TRACKS

- TODDLER
- INTERMEDIATE

FLOW TRACKS

- 3 FUN BIKE TRACKS:
- BEGINNER - ADVANCED COURSES
- RELOADING TRAIL
- BUFFERS AT TOP AND BOTTOM

VEGETATION BUFFER

FEATURES

EXISTING RESIDENTIAL

PUMP TRAIL

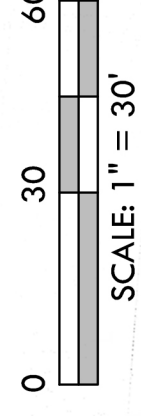
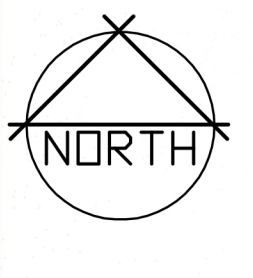

Bille Park - OPTION 1 PHASE 1

CONCEPTUAL DESIGN

PARADISE, CA

7.30.2020



#2376

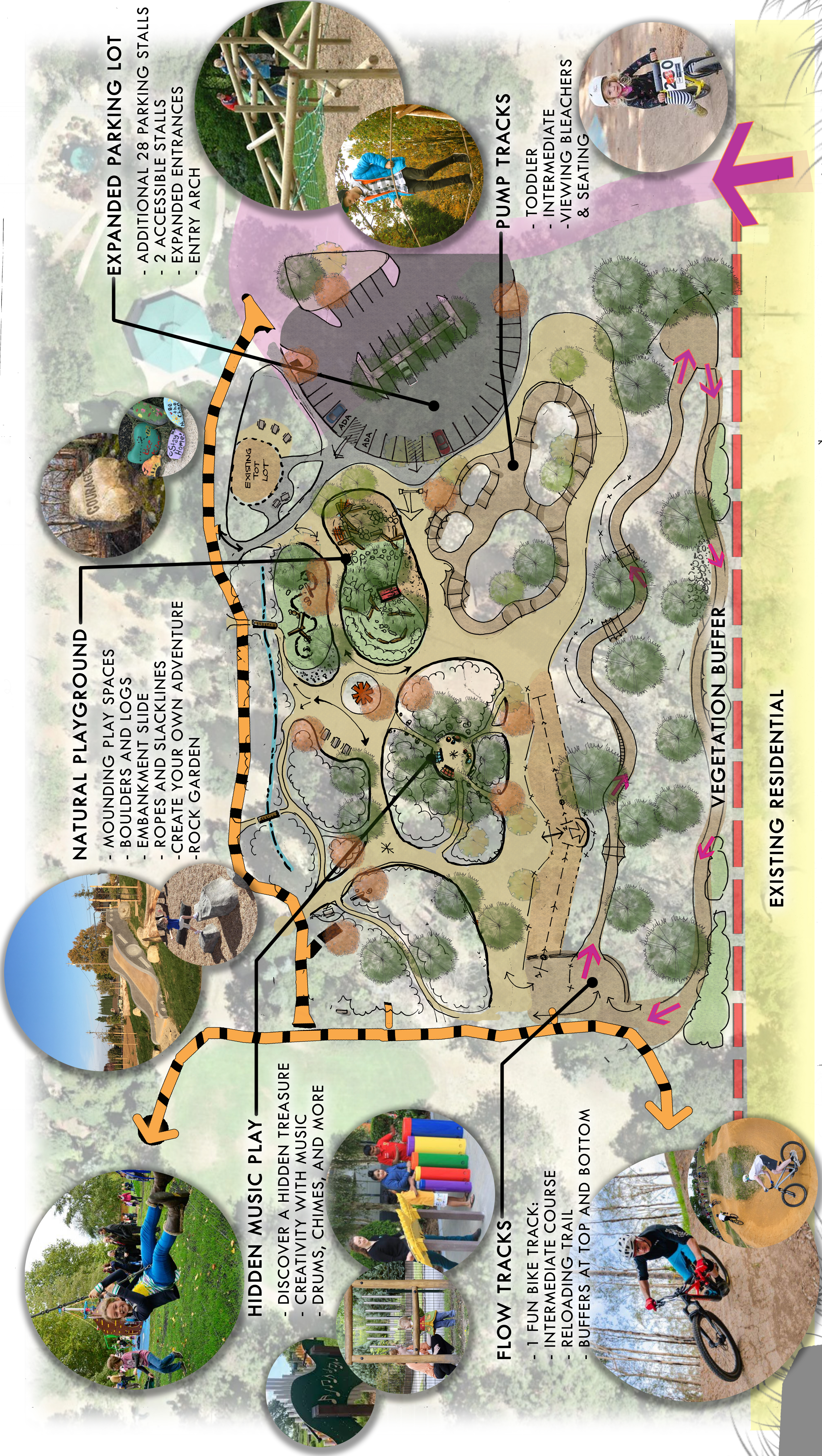

NATURAL PLAYGROUND

- MOUNDING PLAY SPACES
- BOULDERS AND LOGS
- EMBANKMENT SLIDE
- ROPES AND SLACKLINES
- CREATE YOUR OWN ADVENTURE
- ROCK GARDEN

EXPANDED PARKING LOT

- ADDITIONAL 28 PARKING STALLS
- 2 ACCESSIBLE STALLS
- EXPANDED ENTRANCES
- ENTRY ARCH

HIDDEN MUSIC PLAY

- DISCOVER A HIDDEN TREASURE
- CREATIVITY WITH MUSIC
- DRUMS, CHIMES, AND MORE

FLOW TRACKS

- 1 FUN BIKE TRACK:
- INTERMEDIATE COURSE
- RELOADING TRAIL
- BUFFERS AT TOP AND BOTTOM

PUMP TRACKS

- TODDLER
- INTERMEDIATE
- VIEWING BLEACHERS & SEATING

VEGETATION BUFFER

EXISTING RESIDENTIAL

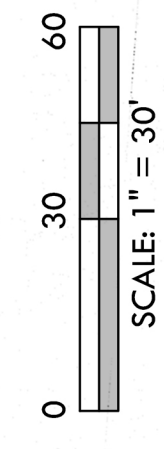
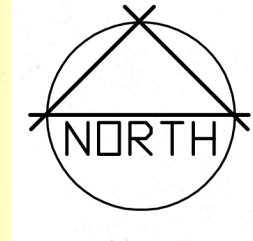

Bille Park - OPTION 2

EXPANDED PARKING LOT

- ADDITIONAL 28 PARKING STALLS
- 2 ACCESSIBLE STALLS
- EXPANDED ENTRANCES
- ENTRY ARCH

ACCESS TO EXISTING TOT LOT & RESTROOM

PUMP TRACKS

- TODDLER
- INTERMEDIATE
- VIEWING BLEACHERS & SEATING

FLOW TRACKS

- 1 FUN BIKE TRACK
- INTERMEDIATE COURSE
- RELOADING TRAIL
- BUFFERS AT TOP AND BOTTOM

VEGETATION BUFFER

EXISTING RESIDENTIAL

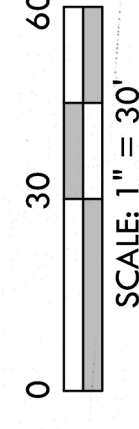
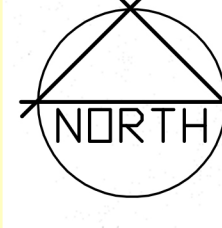

Bille Park - OPTION 2 PHASE 1

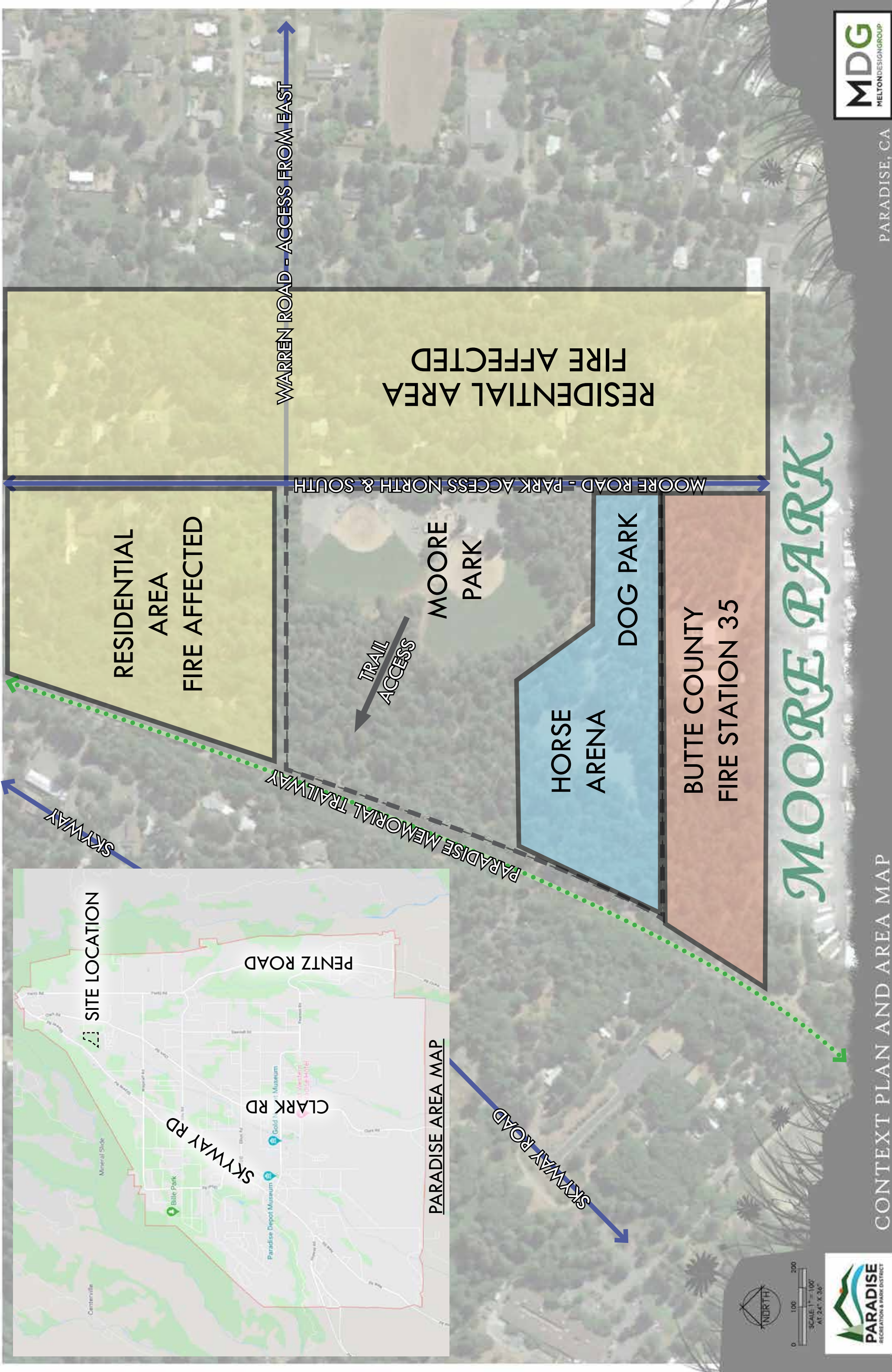

MOORE PARK



EXISTING RESIDENTIAL FIRE AFFECTED

WARREN ROAD

NORTH PARKING (UNMARKED)

DRAINAGE

NORTH ENTRY

CENTRAL PARKING (UNMARKED)

USE FOCUS AREA

PLAYGROUND

POWER

PLANT AREA

MOORE ROAD

SOUTH ENTRY

SOUTH PARKING

DRAINAGE

PLANT AREA

DOG PARK

PARADISE MEMORIAL TRAILWAY

EXISTING RESIDENTIAL - FIRE AFFECTED



MOORE ROAD - NEEDS REPAIRS



RESTROOM AND PROPOSED CORE



VIEW TO CONCESSION & CORE



VIEW TO FIELD 1 & CORE



PARKING LOT #1 - NEEDS REGRADING



EXISTING PLAY AREA & RETAINING WALL



CENTRAL PARKING LOT ELEVATION

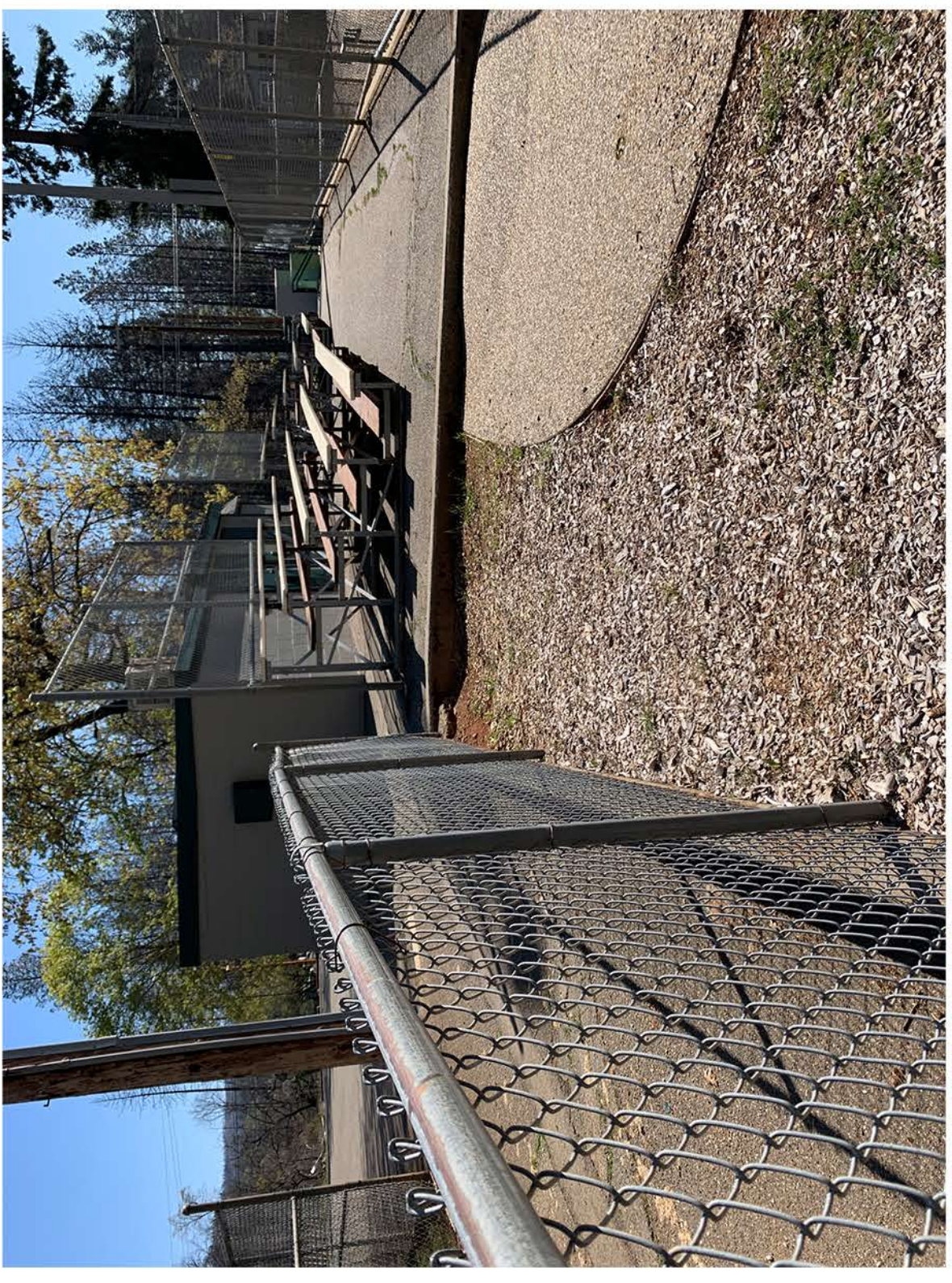

BULLPEN #2 LOCATION



FIELD #1 RAMP & STAIR ACCESS



CONCESSION & STORAGE



WEST TRAIL CONNECTION BETWEEN FIELDS



PARKING LOT #3

Moore Park Core - EXISTING SITE CONDITIONS

CONCEPTUAL DESIGN

PARADISE, CA

8.20.2020



#2402



PROGRAM

- **BASEBALL**
 - BATTING CAGE
 - BULLPENS
 - FIRE SAFETY PARKING
- **BLEACHERS & SHADE**
 - FOLD UP CHAIR SPACE
 - SHADE TREES
- **CONCESSION STAND & STORAGE**
- **PLAYGROUND**
 - BASEBALL THEME
 - INCLUSIVE PENDULUM SWING
 - NATURAL PLAY ELEMENTS
 - GRASSY MOUND
 - LOW STEEL FENCE
- **ARTWORK**
- **BOULDER RETAINING WALL**
 - LANDSCAPING
 - BROADLEAF TREES
- **PICNIC SHADE STRUCTURES**
 - ONE OR TWO STRUCTURE OPTION
- **PARKING & ACCESS**
 - NEW STRIPING
 - SIGNAGE
 - ADA ACCESSIBILITY
 - CIRCULATION PATHS (DG AND CONCRETE)
 - MAINTENANCE ROAD TO CONCESSION AND STORAGE
- **ENTRY MONUMENT/SIGN**



BASEBALL FIELDS



PLAYGROUND & GRASSY MOUND



PICNIC SHADE STRUCTURES

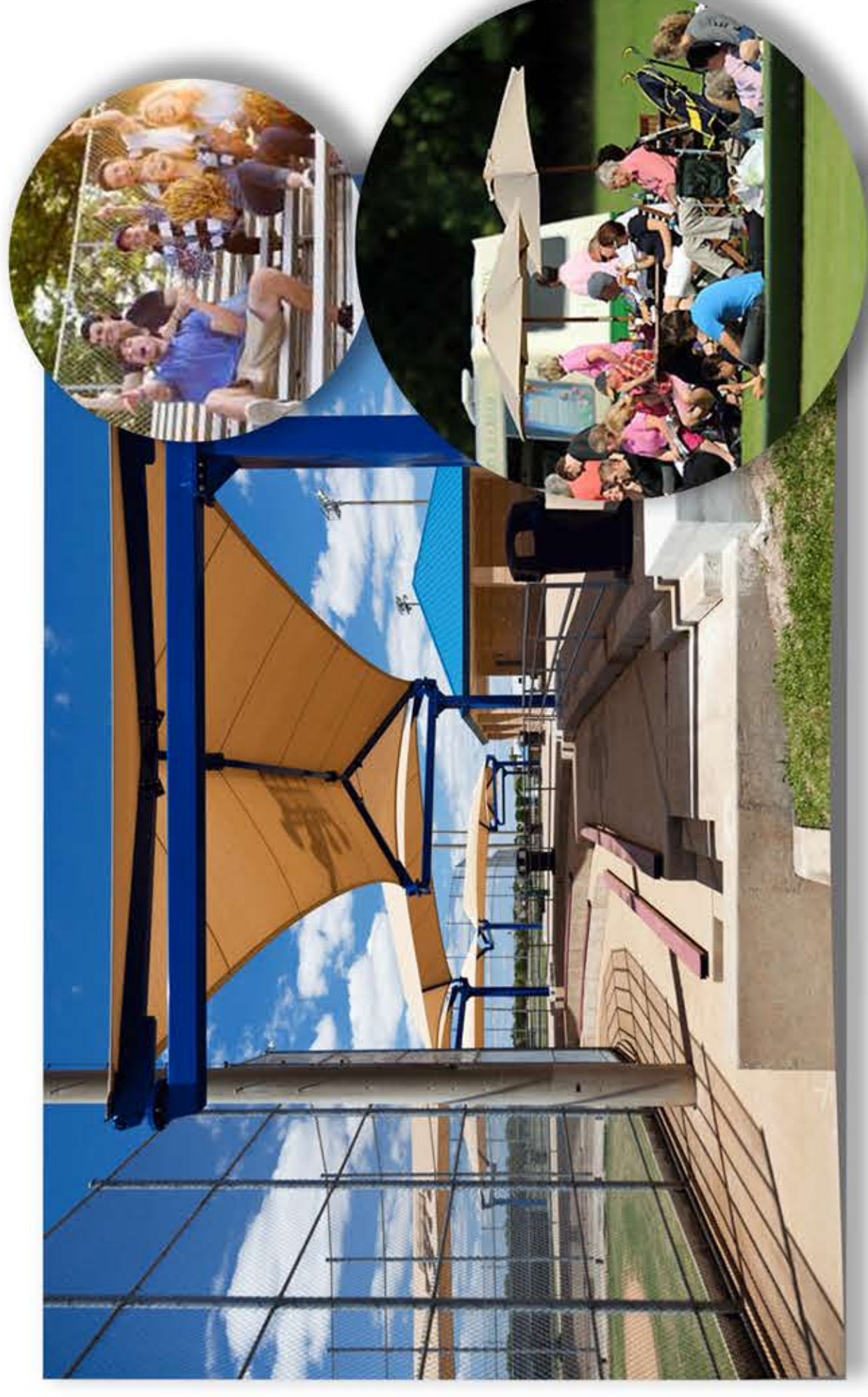

SPECTATOR SHADE AND SEATING

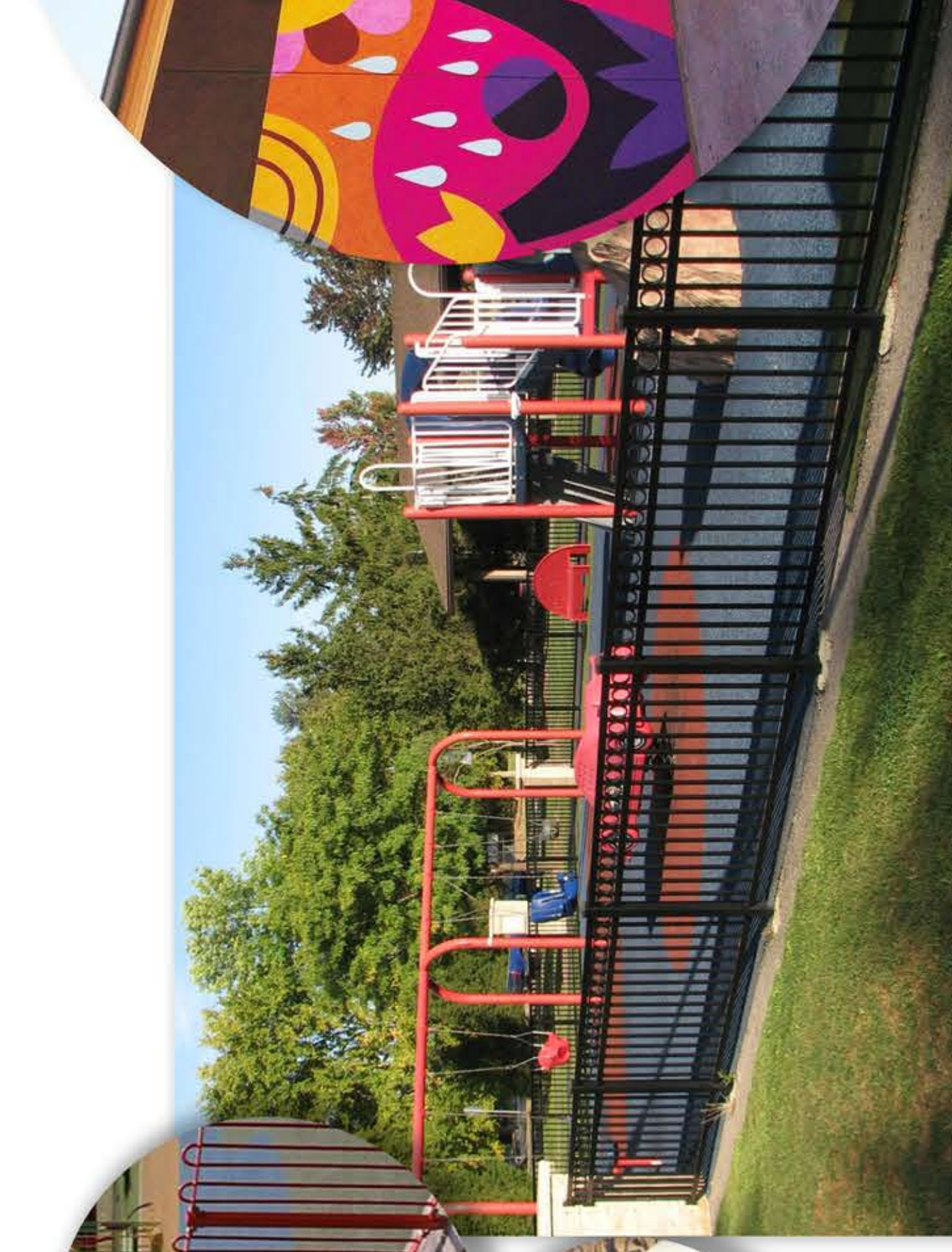

ARTWORK

FENCING

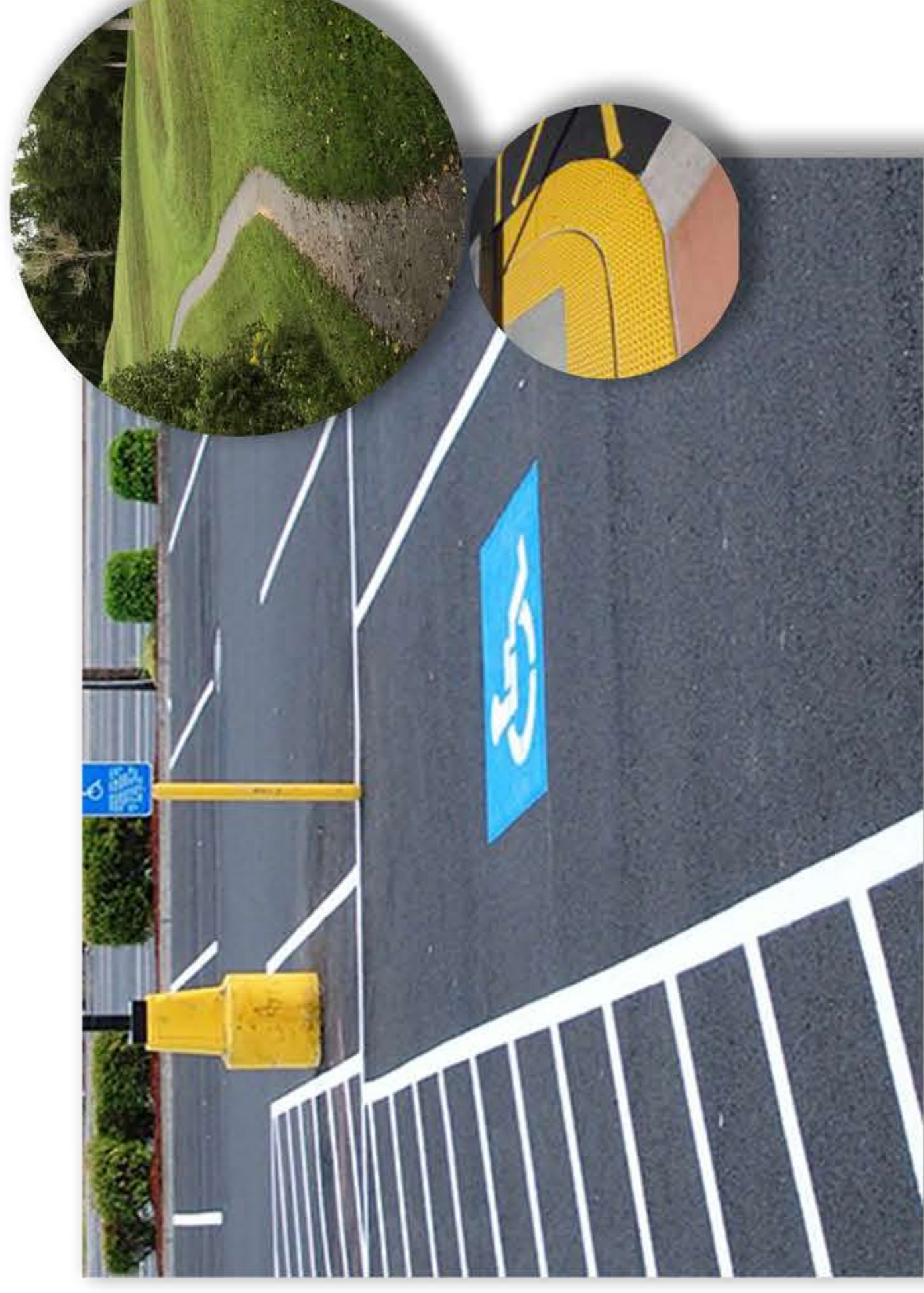

PARKING & CIRCULATION



CONCESSION STAND



RETAINING WALL



ENTRY MONUMENT

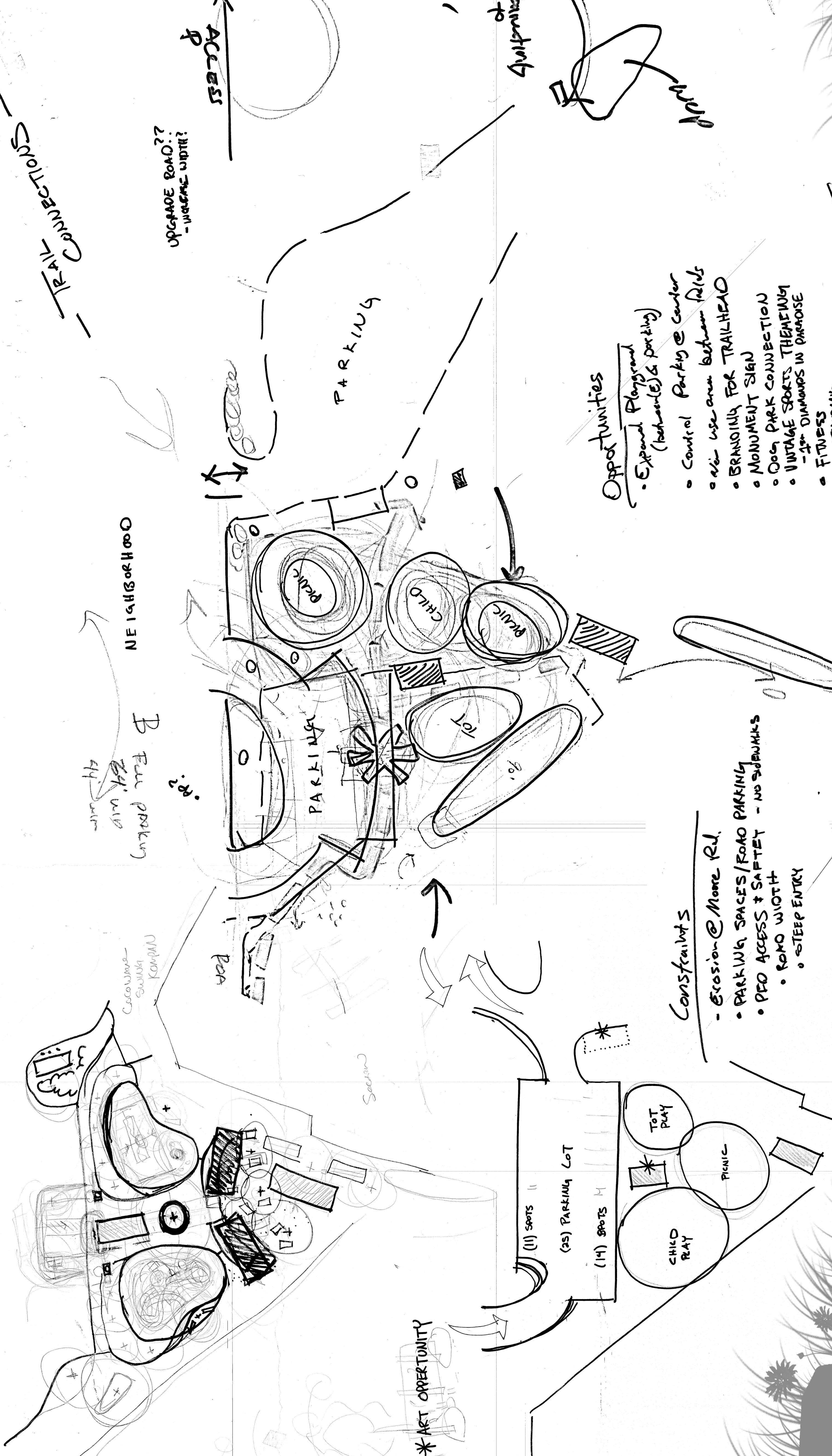

Opportunities

- Expand Playground (behind (E) & parking)
- Control Parking @ Center
- new use area between fields
- BRANDING FOR TRAILHEAD
- MONUMENT SIGN
- DOG PARK CONNECTION
- VINTAGE SPORTS THEMING - 1st DIAMONDS IN PARADISE
- FITNESS
- WAYFINDING

Constraints

- Erosion @ Moore Rd.
- PARKING SPACES / ROAD PARKING
- PEO ACCESS + SAFETY - NO SIDEWALKS
 - ROAD WIDTH
 - STEEP ENTRY

Moore Park Core - PROCESS SKETCH

- Keep trees @ front Bulb
- Snake
- crescent shoulder around tree to Party - Ad @ Concessions
- Entry w/ Spinner

OPPORTUNITIES

- EXPAND PLAYGROUND
- CONTROL PARKING @ CENTER
- ISLANDS
- MONUMENT SIGN
- DOG PARK CONNECTION
- FITNESS
- WALKING/BIKE

CONSTRAINTS

- EROSION @ MOORE RD.
- PARKING SPACES / ROAD PAVING
- PED ACCESS & SAFETY → EXPAND ROAD WIDTH?
 - ROAD WIDTH
 - STEEP ENTRY

MOORE PARK

OPTION #2

20 SCALE

Moore Park Core - PROCESS SKETCH

CONCEPTUAL DESIGN

PARADISE, CA

8.20.2020



#2402



PARKING CALCULATION

EXISTING PARKING = 56 SPACES TOTAL
2 ADA

PROPOSED PARKING = 69 SPACES TOTAL
2 ADA
(+ 13 SPACES)

FIELD #1

EASILY ACCESSIBLE FOR
EMERGENCY FIRE SAFTEY PARKING

BULLPEN #3
TRAIL CONNECTION

BULLPEN #2

CONCESSION STAND

- LOCAL ARTIST TO PAINT
NATURE/BASEBALL
THEMED MURAL

RESTROOM

- LOCAL ARTIST TO PAINT
NATURE/BASEBALL
THEMED MURAL
- FUN TEAM PICTURE SPOT

PICNINIC AREA

- WIDE LANDSCAPE BUFFER
TO PARKING AND ROAD
- SHADE STRUCTURE W/
METAL ROOF

SHADED PICNIC AREA

- BROADLEAF SHADE TREES
- PICNIC TABLES IN DG

PLAYGROUND

- AGES 2-12
- NATURE/BASEBALL THEME
- LOW STEEL FENCE W/
OPENINGS
- CLIMBING BOULDER
- PLAY STRUCTURE W/ SLIDES
- SWING & NATRAL PLAY ELEMENTS

ENTRY AREA

- SHADED ENTRY W/ BOULDERS
- LARGE LANDSCAPE BUFFER TO
PARKING LOT AND ROAD

**OVERFLOW PARKING
& ONE WAY EXIT**

- 16 SPACES
- GRAVEL
- SIGNAGE

PARKING LOT #1

- 30 SPACES
- RE-STRIPE PAINT

PARKING LOT #3

- 18 SPACES
- ADD PAINT STRIPES

MONUMENT SIGN & LANDSCAPE

- THEMED MOORE PARK MONUMENT SIGN
- BOULDER RETAINING WALLS
- NATIVE GRASSES & SHADE TREES

PARKING LOT #2 (PROPOSED)

- 5 SPACES TOTAL
- 2 ADA
- EASY ENTER AND EXIT DRIVEWAY

NEW ANNOUNCERS BOX

- TO MATCH FIELD #1

FIELD #2

EASILY ACCESSIBLE FOR
EMERGENCY FIRE SAFTEY PARKING

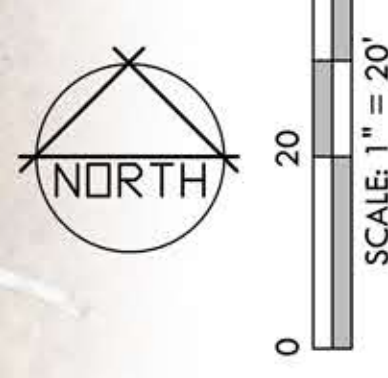

Moore Park - OPTION 1

CONCEPTUAL DESIGN

PARADISE, CA

8.20.2020



#2402



PARKING CALCULATION

EXISTING PARKING = 56 SPACES TOTAL
2 ADA

PROPOSED PARKING = 85 SPACES TOTAL
2 ADA
5 COMPACT
(+ 29 SPACES)

FIELD #1

- EASILY ACCESSIBLE FOR EMERGENCY FIRE SAFTEY PARKING

BATTING CAGE OPPORTUNITY

- 70'X14'
- USE FOR BOTH FIELDS

SHADED PICNIC AREA

- BROADLEAF SHADE TREES
- PICNIC TABLES IN DG

ENTRY PLAZA

- SEATWAL W/ ACCENT TREE
- THEMED MONUMENT ENTRY

GRASSY MOUND

- SPACE TO RELAX
- PROVIDES LANDSCAPE BUFFER

CONCESSION STAND

- LOCAL ARTIST TO PAINT NATURE/BASEBALL THEMED MURAL

PLAYGROUND

- AGES 2-12
- NATURE/BASEBALL THEME
- LOW STEEL FENCE W/ OPENINGS

OVERFLOW PARKING & ONE WAY EXIT

- 16 SPACES
- GRAVEL
- SIGNAGE

PARKING LOT #1

- 30 SPACES
- RE-STRIPE PAINT

RESTROOM

- LOCAL ARTIST TO PAINT NATURE/BASEBALL THEMED MURAL
- FUN TEAM PICTURE SPOT

FIELD #2

- EASILY ACCESSIBLE FOR EMERGENCY FIRE SAFTEY PARKING

MAINTENANCE STORAGE SHED

- 10' X 20'
- USE FOR BOTH FIELDS

PARKING LOT #3

- 18 SPACES
- ADD PAINT STRIPES

MONUMENT SIGN & LANDSCAPE

- THEMED ENTRY MOORE PARK SIGN
- BOULDER RETAINING WALLS
- NATIVE GRASSES & SHADE TREES

PARKING LOT #2 (PROPOSED)

- 21 SPACES TOTAL
- 2 ADA, 5 COMPACT
- CONNECTS PARKING LOTS 1 & 3

NEW ANNOUNCERS BOX

- TO MATCH FIELD #1

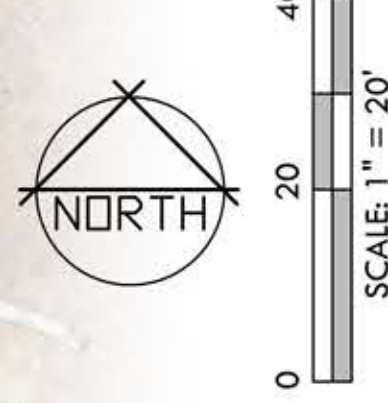

Moore Park - OPTION 2A

CONCEPTUAL DESIGN

PARADISE, CA

7.30.2020



#2402





FIELD #1

- SHADED PICNIC AREA**
- BROADLEAF SHADE TREES
 - PICNIC TABLES IN DG
- ENTRY PLAZA**
- SEATWAL W/ ACCENT TREE
 - THEMED MONUMENT ENTRY

- GRASSY MOUND**
- SPACE TO RELAX
 - PROVIDES LANDSCAPE BUFFER

FIELD #2

- CONCESSION STAND**
- LOCAL ARTIST TO PAINT NATURE/BASEBALL THEMED MURAL
- PLAYGROUND**
- AGES 2-12
 - NATURE/BASEBALL THEME
 - LOW STEEL FENCE W/ OPENINGS

- RESTROOM**
- LOCAL ARTIST TO PAINT NATURE/BASEBALL THEMED MURAL
 - FUN TEAM PICTURE SPOT

- PARKING LOT #2 (PROPOSED)**
- 21 SPACES TOTAL
 - 2 ADA, 5 COMPACT
 - CONNECTS PARKING LOTS 1 & 3

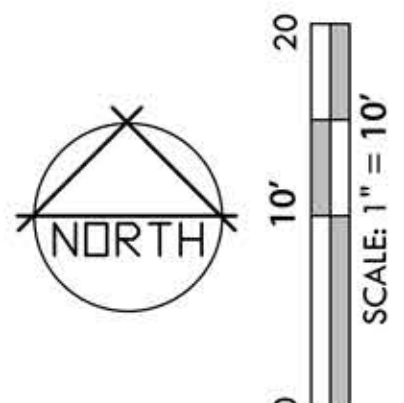

Moore Park Core - OPTION 2A

CONCEPTUAL DESIGN - CORE BLOW UP

PARADISE, CA

SHADE STRUCTURE



FIELD #1

SHADE PICNIC AREA

- BROADLEAF SHADE TREES
- PICNIC TABLES IN DG
- SHADE STRUCTURE

CENTER PLAZA

- CONCRETE SEATWALL
- ACCENT MAPLE TREE

GRASSY MOUND

- SPACE TO RELAX
- PROVIDES LANDSCAPE BUFFER



GRASSY MOUND RELAXATION & PLAY AREA

RETAIN & PROTECT TRANSFORMER



ACCENT MAPLE TREE

CONCESSION STAND

- LOCAL ARTIST TO PAINT NATURE/BASEBALL THEMED MURAL

FIELD #2

PLAYGROUND

- AGES 2-12
- PRECAST BASEBALL THEMED PLAY SCULPTURES
- CONCRETE SEATWALLS



MAINTANANCE ACCESS ROAD

- KEEP AREA CLEAR FOR MAINTENANCE VEHICULAR ACCESS

RESTROOM

- LOCAL ARTIST TO PAINT NATURE/BASEBALL THEMED MURAL
- FUN TEAM PICTURE SPOT



ALL-STAR PRECAST PLAY SCULPTURES

ENTRY PLAZA

- THEMED MONUMENT ENTRY COLUMNS
- BASEBALL SCORN & COLORED CONCRETE MEDALION
- ENTRY ACCENT TREES
- PROVIDES DROP-OFF AREA



STAINED CONCRETE ENTRY ART

STEEL ENTRY COLUMN/PANELS

- PARKING LOT #2 (PROPOSED)**
- 19 SPACES TOTAL
- 2 ADA
- CONNECTS PARKING LOTS 1 & 3

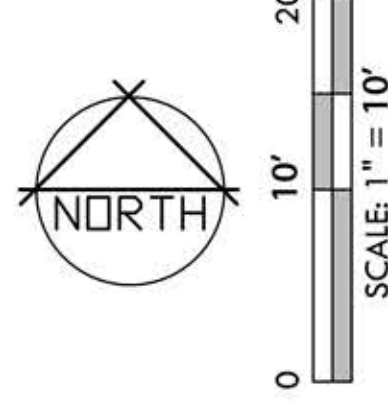

Moore Park Core - OPTION 2B

CONCEPTUAL DESIGN - CORE BLOW UP

PARADISE, CA

8.20.2020



#2402





FIELD #1

SHADED PICNIC AREA
 - BROADLEAF SHADE TREES
 - PICNIC TABLES IN DG

ENTRY PLAZA
 - SEATWALL W/ ACCENT TREE
 - THEMED MONUMENT ENTRY

GRASSY MOUND
 - SPACE TO RELAX
 - PROVIDES LANDSCAPE BUFFER

CONCESSION STAND
 - LOCAL ARTIST TO PAINT NATURE/BASEBALL THEMED MURAL

PLAYGROUND
 - AGES 2-12
 - NATURE/BASEBALL THEME
 - LOW STEEL FENCE W/ OPENINGS

RESTROOM
 - LOCAL ARTIST TO PAINT NATURE/BASEBALL THEMED MURAL
 - FUN TEAM PICTURE SPOT

PARKING LOT #2 (PHASED)
 - 8 SPACES TOTAL
 - 2 ADA

TEMPORARY PICNIC & PLAY AREA
 - NATURAL PLAY ELEMENTS TO BE EASILY RELOCATED ON SITE
 - PICNIC TABLES
 - TEMPORARY FENCE AROUND PLAY AREA
 - STEEL EDGING

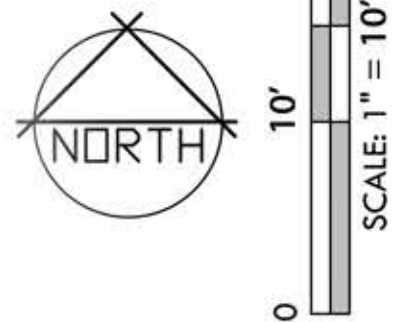

Moore Park Core - PHASE 1

CONCEPTUAL DESIGN - CORE BLOW UP

PARADISE, CA